

MICRON SIDE MOUNT COMMERCIAL FILTERS

Part Number	Product Description	Diagram Number
6209440	Man Hole Cover 4 Stud Complete	1
621621	Pressure Gauge Dry 600KPA/90PSI Bottom Mount	2
6340939	Hex Nut M16 (4 required)	3
6340937	Washer M16 S/S304 (8 required)	4
6209430	Lid Yoke Lacron (2 required)	5
W12324	Hex Thin Nut (4 required)	6
6209443	O Ring Manhole Cover Oval 4 Stud - Waterco	7
W12724	S/S Screw 1" BSW Male 1/4" BSP Female Thread	8
6209442	Manhole Cover Only Oval 4 Stud - Waterco	9
6340412	O Ring BS113 (4 required)	10
W12125	Hex Bolt N16X120MM (4 required)	11
6340803	80mm Half Union Black (2 required)	12/13
6340801	100mm Half Union Black (2 required)	12/13
6302550	O Ring B/U 80mm	14
6302553	O Ring B/U 100mm	14
6209303	Drain Plug complete 40mm	15/16/17/18
620940	Funnel For Port Size 3" & 4" (80mm & 100mm) (4 required)	19
620223	Air Relief Tube Screen	20
86172	Gulfstream Plug (only 2 required)	21
620221	Air Relief Valve	22
6202321	Handle for lid 12" (2 required)	23
W02630	Lid 12"	24
620232	Lock Ring 12"	25
6202321	Screwed handle for 12" lock ring (4 required)	26
63406565B	Half union 65mm c/w O ring (2 required)	27

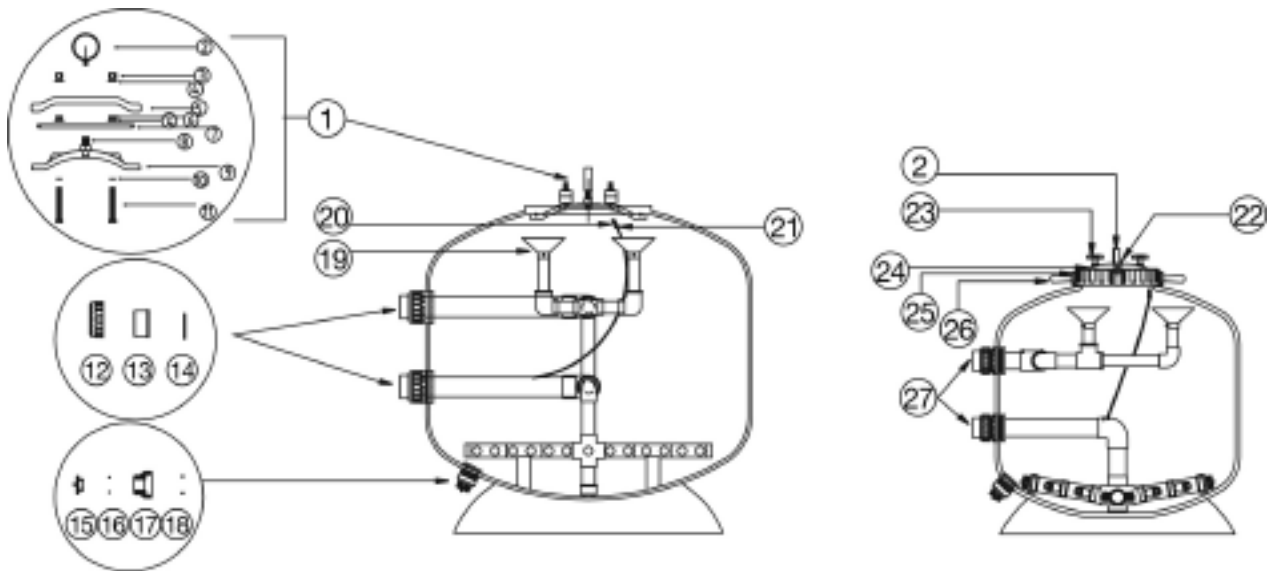

Part No:	Manifold	620921	620922	620923	620924	620925	6209251	6208931	6208932	6208933	6200912	W02269BLK	W02270BLK
		LATERALS				Lateral End Cap Nut	Lateral End Plug (male)	Hz Cross Tee	Hz LCT Extension	Hz LCT End Cap	Extension Arm	Cap Body	Cap Nut
Model		75mm	110mm	145mm	200mm								
SM1050 65mm Port	65mm	8	16	-	12	20	-	-	-	-	8	4	4
SM1050	80mm	8	20	10	4	32	4	2	8	4	-		
SM1200 65mm Port	65mm	16	4	20	12	28	-	-	-	-	12	4	4
SM1200	-	2	26	8	6	32	4	2	8	4	-		
SM1400	-	8	8	36	14	48	4	2	12	4	-		
SM1600 80mm Port	-	4	16	42	18	48	4	2	12	4	-		
SM1600 100mm Port	-	10	22	22	38	-	60	-	-	-	-		
SM1800	-	8	42	22	68	-	76	-	-	-	-		
SM2000	-	2	52	20	74	-	80	-	-	-	-		
SM2200 100mm Port	-	20	34	78	88		96				-		
SM2200 150mm Port	-	64	34	30	88	-	96	-	-	-	-		